

**SOIL MAP LEGEND**

- STONES
- TEST HOLE
- WET SPOT
- HYDRIC SOIL
- SHALLOW-TO-BEDROCK SOIL (< 20')

**SOIL SURVEY NOTES**

1. SOILS MAPPING WAS CONDUCTED ON (DATE HERE) IN ACCORDANCE TO MAPPING STANDARDS ESTABLISHED FOR A CLASS B (HIGH INTENSITY) SOIL MAPPING INVESTIGATION AS DESCRIBED IN THE PUBLICATION GUIDELINES FOR MAINE CERTIFIED SOIL SCIENTISTS FOR SOIL IDENTIFICATION AND MAPPING, (MAINE ASSOCIATION OF PROFESSIONAL SOIL SCIENTISTS, 2009) EXCEPT THAT CONTOURS AND TEST HOLE LOCATIONS WERE SKETCHED IN THE FIELD USING A HAND COMPASS, A 100' TAPE, AND A CLINOMETER. GROUND CONTROL WAS ESTABLISHED BY ORIENTATING FIXED LANDSCAPE FEATURES TO MAP FEATURES. THIS PLAN SHOULD BE USED AND INTERPRETED IN CONJUNCTION WITH THE ACCOMPANYING SOIL MAPPING REPORT BY (INSERT NAME & DATE HERE) TO SUPPORT PERMITTING OF THE PROPOSED DEVELOPMENT IN (TOWN), MAINE.
2. BASE MAPS INCLUDED THE TOWN OF (INSERT TOWN) TAX MAP 8 LOT 10 AND THE USGS 7.5 MINUTE SERIES (INSERT NAME) TOPOGRAPHIC MAP. TEST PITS WERE SELECTED IN THE FIELD BASED ON PERCEIVED DIFFERENCES IN TOPOGRAPHY, AND/OR VEGETATION. THEN HAND DUG USING A SHOVEL. OBSERVATIONS DEEPER THAN A DEPTH OF ABOUT 20" WERE MADE USING A DUTCH AUGER. DEPTH TO BEDROCK IN CERTAIN AREAS WAS DETERMINED BY USING A STEEL BEDROCK PROBE.

**SOIL MAP LEGEND**

SYMBOL	SERIES AND SLOPE PHASE	HYDROLOGIC SOIL GROUP
AbB	ABRAM LOAM, 3-8% SLOPES	D
BrB	BRAYTON SANDY LOAM, 3-8% SLOPES	C
BsB	VERY STONY BRAYTON SANDY LOAM, 3-8% SLOPES	C
BsC	VERY STONY BRAYTON SANDY LOAM, 8-15% SLOPES	C
CgB	GRAVELLY COLONEL LOAM, 3-8% SLOPES	C
CoB	COLONEL LOAM, 3-8% SLOPES	C
CeC	COLONEL LOAM, 8-15% SLOPES, ERODED	C
DxA	DIXFIELD LOAM, 1-3% SLOPES	C
DxD	DIXFIELD LOAM, 8-15% SLOPES	C
DxD	DIXFIELD LOAM, 15-30% SLOPES	C
LyB	LYMAN LOAM, 3-8% SLOPES	C/D
TsC	STONY TUNBRIDGE LOAM, 8-15% SLOPES	C
TuC	TUNBRIDGE SANDY LOAM, 8-15% SLOPES	C
UdB	UDIPSAMMENTS (GRAVEL FILL), 1-8% SLOPES	-
UdC	UDIPSAMMENTS (GRAVEL FILL), 8-15% SLOPES	-

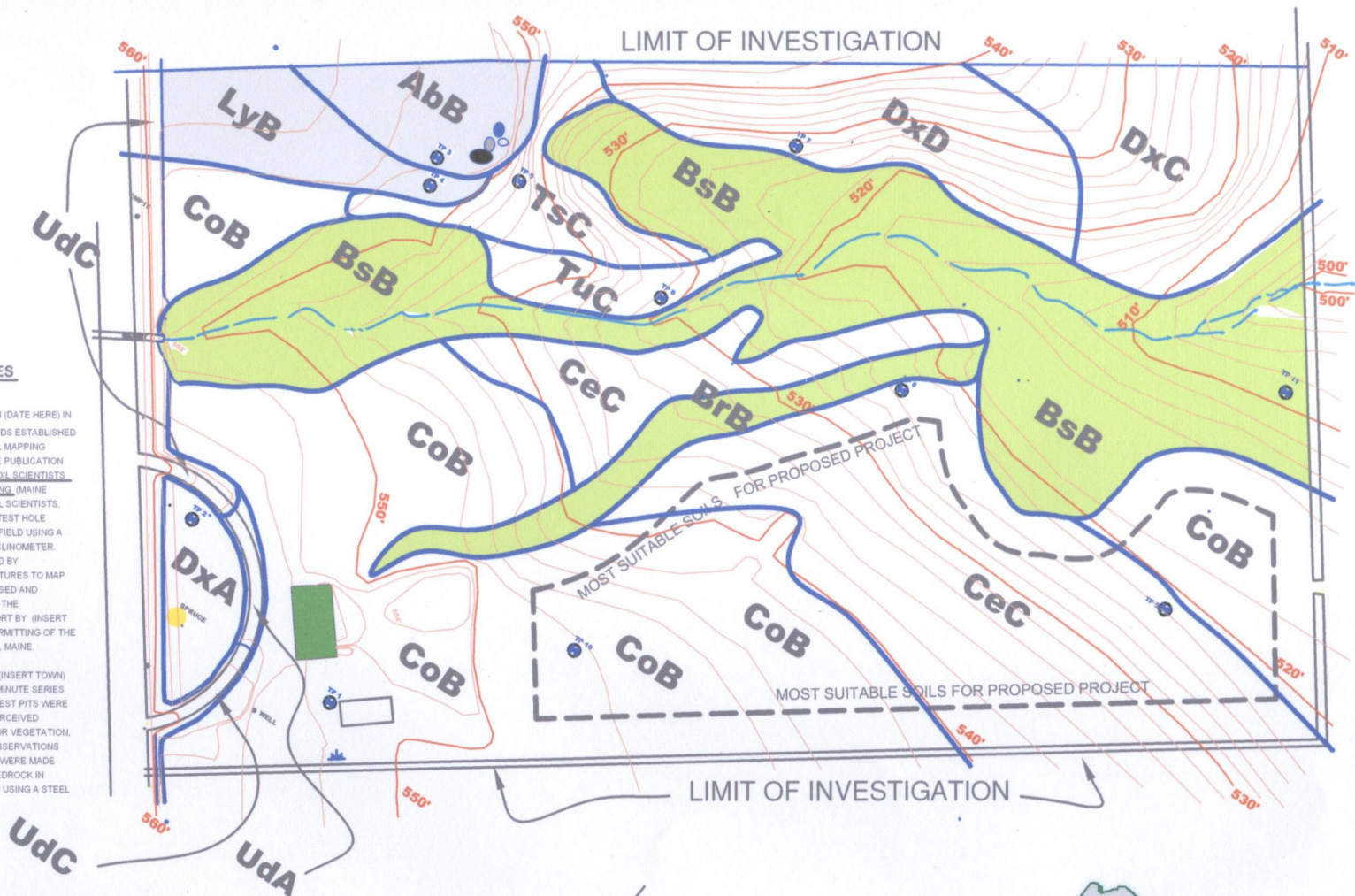

MAGN N

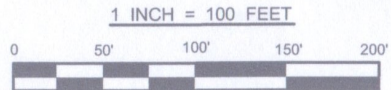

CONTOUR INTERVAL = 2 FEET

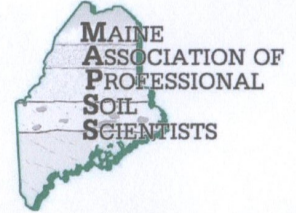

**FOR MORE INFORMATION ON HOW TO CONTACT A LOCAL CERTIFIED SOIL SCIENTIST FROM THE MAINE ASSOCIATION OF PROFESSIONAL SOIL SCIENTISTS, GO ON-LINE TO [WWW.MAPSS.ORG](http://WWW.MAPSS.ORG) .**